

FOR LEASE IN CARY

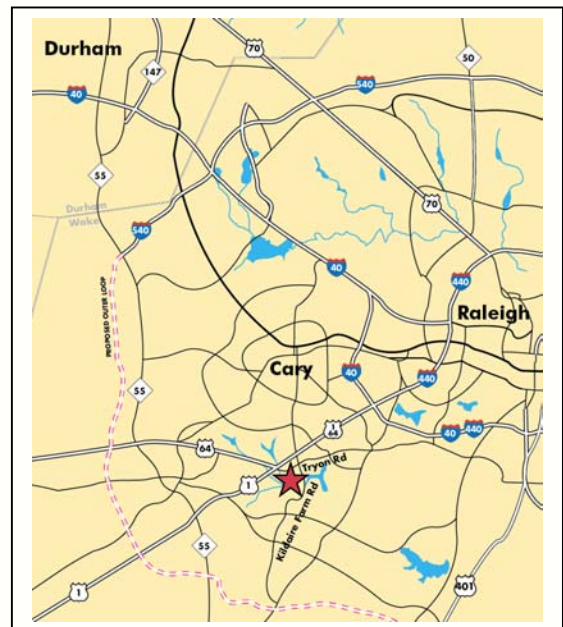

1400 CRESCENT GREEN +/- 1,443 RSF AVAILABLE ON 2ND FLOOR

- Available Immediately.
- A 50,000 sf, 3-story Class A office building; Traditional entry-level lobby features an elegant blend of granite with inlaid carpet, fabric wall covering, and an open monumental stair.
- \$22.50 psf full-service rental rate.
- Showers are located in the building; 4.0 parking spaces per 1,000 sf leased, with limited underground parking.
- Existing offices, break room, conference areas, and interior glass.
- Nearby amenities include shopping, banking, hotels, and restaurants with housing in all price ranges in close proximity to the site.
- Upfit allowance negotiable.



1400 CRESCENT GREEN
CARY, NORTH CAROLINA 27518

CAPITAL ASSOCIATES®

Bret Muller (919) 233-9901 phone (919) 233-9905 fax

1400 CRESCENT GREEN

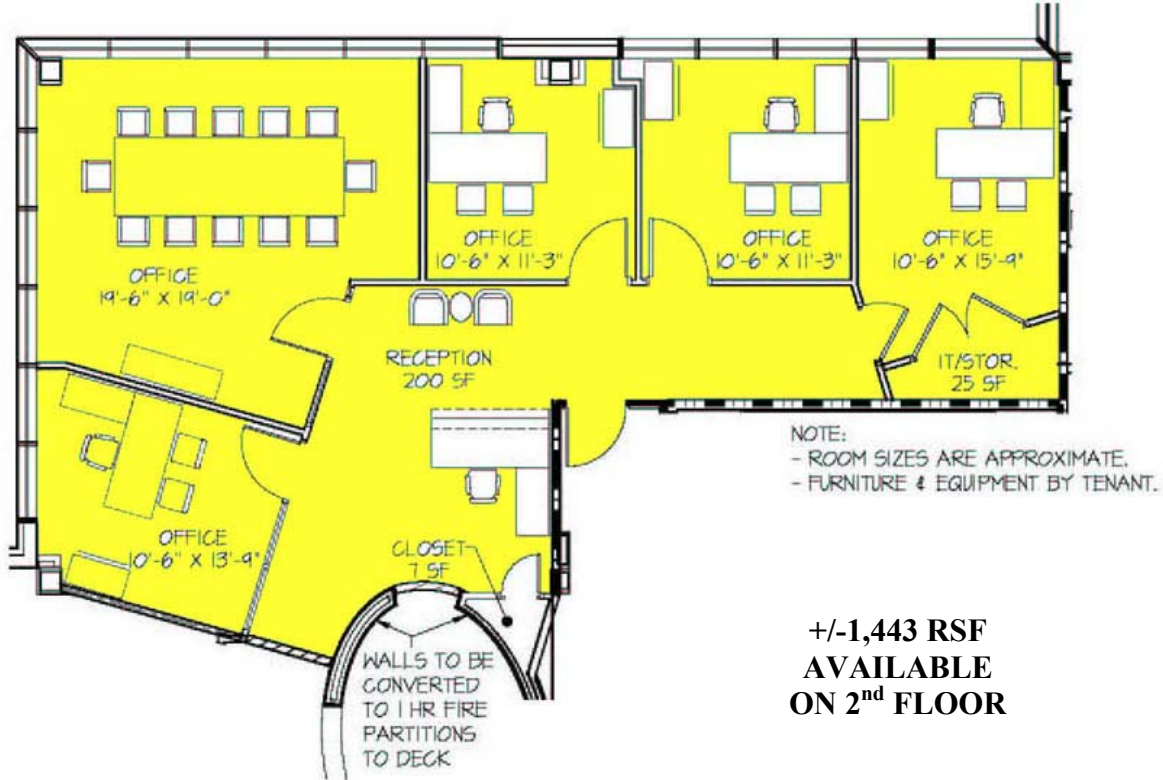

**Lobby
Entrance**

For more information, contact: **Bret Muller (919) 233-9901**
Email bmuller@casso.com or visit www.casso.com

Information provided herein is secured from sources presumed to be reliable. However, all information is subject to verification.

l e a s i n g & m a n a g e m e n t b y
CAPITAL ASSOCIATES®

1255 Crescent Green, Suite 300 Cary, North Carolina 27518 (919) 233-9901 phone (919) 233-9905 fax